



CHAMAEROPS HUMILIS



LITTLE OLLIE DWARF OLIVE

EXISTING PLANT LEGEND

	PLANTING SIZE	SCIENTIFIC NAME	COMMON NAME
○ 4	EXISTING TO REMAIN	WASHINGTONIA ROBUSTA	MEXICAN FAN PALM
CH 2	EXISTING TO REMAIN	CHAMAEROPS HUMILIS	MEDITERRANEAN FAN PALM
BO 2	EXISTING TO REMAIN	BOUGAINVILLEA 'B. KARST'	BOUGAINVILLEA
LC ALL	EXISTING TO REMAIN	LANTANA 'NEW GOLD'	NEW GOLD LANTANA
OL ALL	EXISTING TO BE REMOVED	NERIUM OLEANDER	OLEANDER

PLANTING LEGEND

ACCENT/SHRUBS	PLANTING SIZE	SCIENTIFIC NAME	COMMON NAME
★	3	24" BOX MULTI TR.	CHAMAEROPS HUMILIS
⊕	13	5-GAL.	CARISSA 'BOXWOOD BEAUTY'
☼	6	5-GAL.	CARISSA 'GREEN CARPET'
☼	3	15-GAL.	DASYLIRION WHEELERI
☼	6	5-GAL.	LITTLE OLLIE
☼	10	5-GAL.	LEUCOPHYLLUM 'GRAY CLOUD'
⊕	10	3'-4' DIA	DESERT SELECT BOULDERS BY SOUTHWEST BOULDER AND STONE
DG		2' DEPTH 3/8" MINUS COMPACTED BRIMSTONE DECOMPOSED GRANITE BY SOUTHWEST BOULDERS AND STONE	
OPTIONAL		4"-6" DIA. HICKORY CREEK FRACTURED GRANITE BY SOUTHWEST BOULDER AND STONE	
		1050 SQ.FT. OF EXISTING TURF TO BE REMOVED	

PLANTING NOTES

- PLANTING AREAS TO RECEIVE A 2" MIN. LAYER OF BRIMSTONE DECOMPOSED GRANITE BY SOUTHWEST BOULDERS AND STONE
- PLANT QUANTITIES INDICATED IN THE PLANT LIST ARE FOR CONTRACTOR'S CONVENIENCE ONLY. CONTRACTOR TO VERIFY PLANT QUANTITIES PER PLAN PRIOR TO BID. CONTRACTOR TO PROVIDE AND INSTALL ALL PLANTS INDICATED PER PLAN.
- ALL TREES WITHIN FIVE FEET OF PAVING SHALL BE INSTALLED WITH APPROVED DEEP ROOT BARRIER.

Important Notice - Underground Service Alert



Section 4216/4217 of the Government Code requires a Dig Alert Identification Number be issued before a 'Permit to Excavate' will be valid. For your Dig Alert Identification Number call Underground Service Alert TOLL FREE at 1-800-227-2600 two working days before you dig.

Construction contractor agrees that in accordance with generally accepted construction practices, construction contractor will be required to assume sole and complete responsibility for job site conditions during the course of construction of the project, including safety of all persons and property; that this requirement shall be made to apply continuously and not be limited to normal working hours, and construction contractor further agrees to defend, indemnify and hold design professional harmless from any and all liability, real or alleged, in connection with the performance of work on this project, excepting liability arising from the sole negligence of design professional.



DASYLIRION WHEELERI



CARISSA 'GREEN CARPET'



CARISSA 'BOXWOOD BEAUTY'

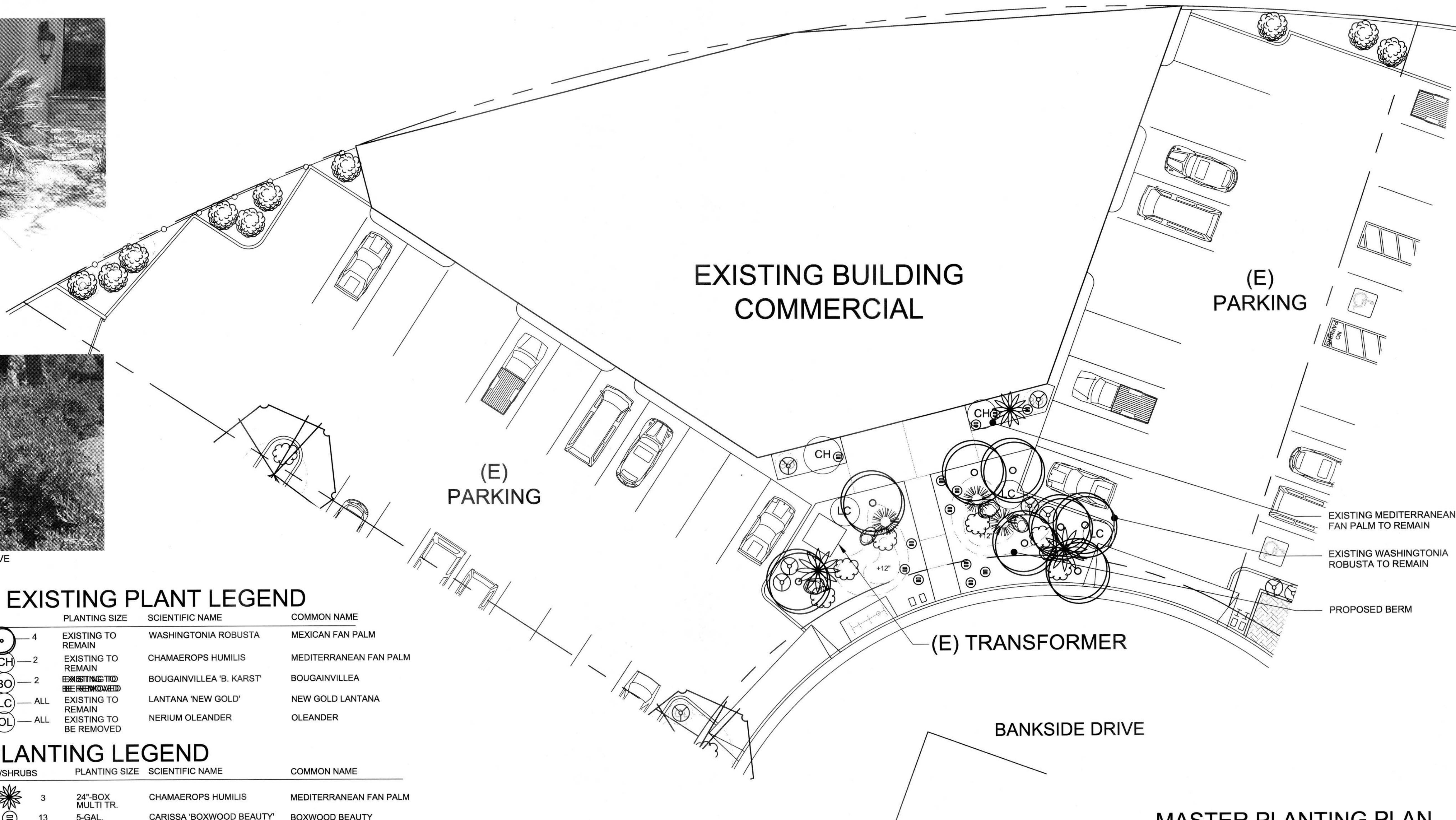

MASTER PLANTING PLAN

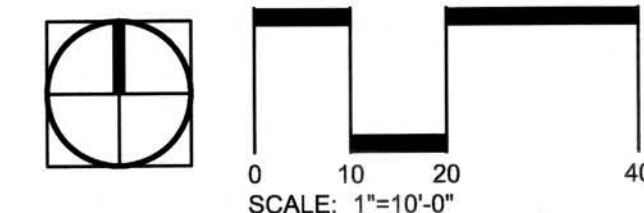

LANDSCAPE ARCHITECTURAL SERVICES BY:

DESERT MODERN
LANDSCAPE DESIGN

LANDSCAPE PLANS FOR

DESERT FLOWER COLLECTIVE INC.
36-425 BANKSIDE DRIVE
CATHEDRAL CITY, CALIFORNIA 92234

DESERT MODERN
LANDSCAPE DESIGN
401 S. EL CIELO ROAD #100
PALM SPRINGS, CALIFORNIA 92262
TELEPHONE (760) 597-1844 Email: desertmodern@desertmodern.com
www.desertmodern.com

D.W. JOHNSTON
CONSTRUCTION INC.
1401 N. Sunrise Hwy. Suite 20
PALM SPRINGS, CALIFORNIA 92262
TELEPHONE (760) 418-1144
www.dwjconstruction.com

REVISION
09-19-16

SCALE: 1"=10'-0"

SHEET
L-1.0