

"A CONDITIONAL USE PERMIT"

IN THE CITY OF CATHDERAL CITY, STATE OF CALIFORNIA Cathedral City Collective

BEING A PORTION OF SECTION 33, TOWNSHIP 4 SOUTH, RANGE 5 EAST,
SAN BERNARDINO MERIDIAN

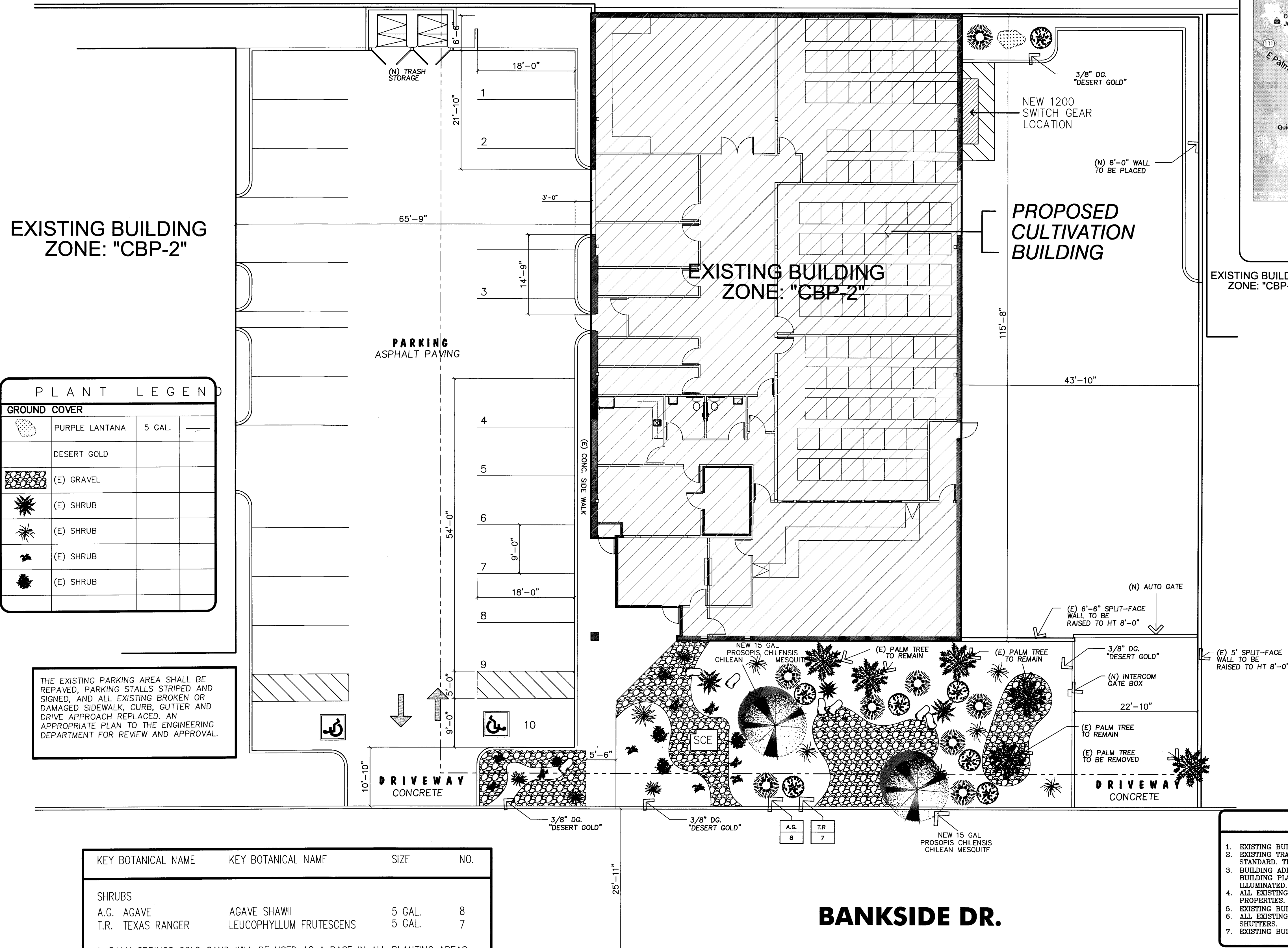

VICINITY MAP

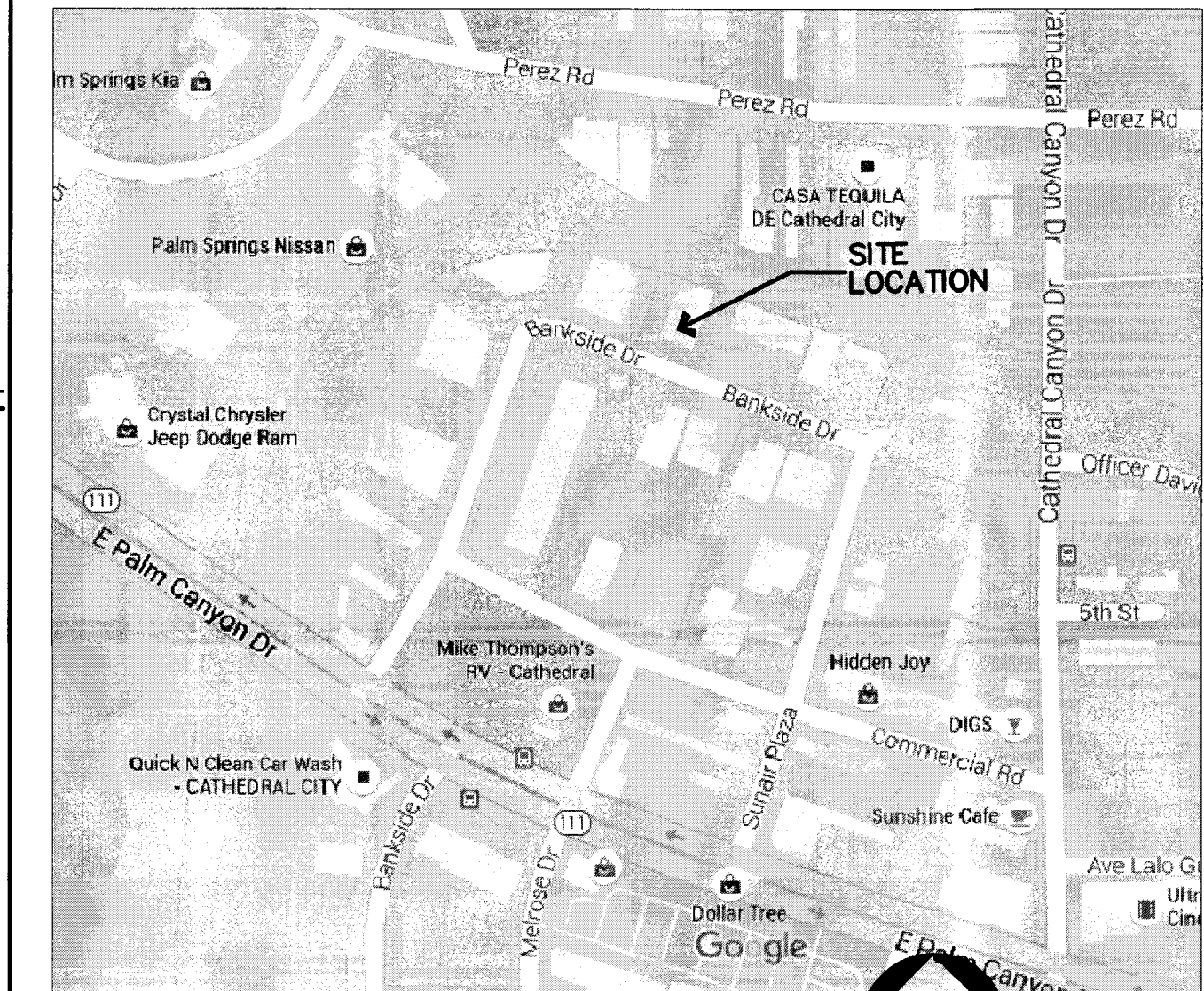

UTILITY PURVEYORS

SEWER & WATER:	COACHELLA VALLEY WATER DISTRICT	(760) 398-2651
TELEPHONE:	VERIZON	(800) 481-5000
ELECTRICITY:	SOUTHERN CALIFORNIA EDISON	(800) 655-4555
GAS:	SOUTHERN CALIFORNIA GAS COMPANY	(800) 427-2200
CABLE:	TIME WARNER CABLE	(760) 340-2225
SCHOOL:	PALM SPRINGS UNIFIED SCHOOL DISTRICT	(760) 416-6000

GENERAL INFORMATION

OWNER/APPLICANT/DEVELOPER:

CATHEDRAL CITY COLLECTIVE
36385 BANKSIDE DR.
CATHEDRAL CITY, CA. 92234

PROJECT ADDRESS:

36385 BANKSIDE DR.
CATHEDRAL CITY, CA. 92234

ASSESSOR'S PARCEL NO:

687-311-010-9

ACREAGE:

GROSS: .49 ± ACRES

LEGAL DESCRIPTION:

Recorded Book/Page: MB 103/4
Subdivision Name: TR 6066
Lot/Parcel: 7
Block: Not Available
Tract Number: 6066

SITE DATA:

EXISTING BUILDING: 7,743 SQ. FT. 33%
TOTAL LANDSCAPE AREA: 2,756 SQ. FT. 13%
TOTAL HARDSCAPE AREA: 10,061 SQ. FT. 49%
LAND AREA: ± 20,560 SQ. FT. (.49 ac)

CATHEDRAL CITY GENERAL NOTES

- EXISTING BUILDING TO BE CONNECTED TO PUBLIC SEWER. OWNER TO VERIFY POINT OF CONNECTION.
- EXISTING TRASH ENCLOSURE TO BE REWORKED AS NEEDED SO AS TO COMPLY WITH EXISTING CITY STANDARD. THE LOCATION MUST BE APPROVED BY THE LOCAL WASTE HAULER BURRTEC.
- BUILDING ADDRESS NUMERALS TO BE A MINIMUM OF 12" IN HEIGHT AND SHALL BE PLACED ON THE BUILDING PLAINLY VISIBLE FROM THE PUBLIC STREET AND SHALL BE INTERNALLY OR EXTERNALLY ILLUMINATED.
- ALL EXISTING EXTERIOR LIGHTING MUST BE SHIELDED TO PREVENT SPILL-OVER TO ADJACENT PROPERTIES.
- EXISTING BUILDING TO BE REPAINTED AND/OR TOUCHED UP AS NEEDED.
- ALL EXISTING WINDOWS, DOORS, AND STOREFRONT OPENINGS TO BE SECURED VIA ELECTRICAL SHUTTERS.
- EXISTING BUILDING IS FIRE SPRINKLED.

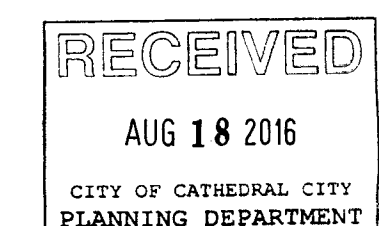

SITE PLAN
SCALE: 1" = 10'-0"

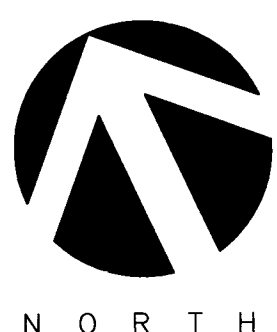

GABRIEL LUJAN & ASSOCIATES

GABRIEL LUJAN & ASSOCIATES
DESIGN • LAND PLANNING
DRAFTING •
GABRIEL LUJAN
PRINCIPAL DESIGNER
36-947 COOK ST., STE. 104
PALM DESERT, CA. 92211
CELL: (760) 578-8345 FAX: (760) 674-8100
EMAIL: g@gabrielgroup.com

A CONDITIONAL USE PERMIT FOR:
CATHEDRAL CITY COLLECTIVE
36-385 BANKSIDE DR. CATHEDRAL CITY, CA.

REVISIONS	BY
BLDG. DEPT. CHECK	GLA

SHEET TITLE:

**PRELIMINARY
SITE PLAN**

DRAWN:	GLA
CHECKED:	GLA
DATE:	MARCH 2016
SCALE:	AS NOTED
JOB NO.:	CC0308-2016

SHEET

P1

Printed On: 08/17/16